

# TN-16 微電腦計碼器

Micro Computer Yarn Meters



TN-16A



TN-16C

## 微電腦計碼器

1. 超大型LED顯示，讀取容易。
2. 以按鍵輸入，設定容易。
3. 最大設定值99,999米。
4. 運轉值與設定值同顯示，繞線長度一目了然。
5. 斷紗自動停止 (TN-16A)
6. 單錠控制、獨立運作。
7. 繞滿自停並自動歸零，適用於一般長度及數量測定。
8. 適用電壓：220V。

## Micro Computer Yarn Meters

1. Large LED display for easy reading.
2. Input by buttons for easy setting.
3. Max. Setting value 99,999 meters.
4. Running & setting values displayed simultaneously for easy checking the winding length.
5. Auto stop & when yarn breaking (TN-16A)
6. Individual spindle control & operation.
7. Auto stop & auto reset when finish winding. Suitable for length and quantity measurement.
8. Power supply : 220V.

### FACTORY

泰能機器工業股份有限公司  
TAINING MACHINE INDUSTRIAL CO., LTD.

台灣43251台中市大肚區沙田路三段734巷35號  
35, Lane 734, Sec 3, Sha Tien Rd., Dadu Dist.,  
Taichung City 43251, Taiwan  
TEL: 886-4-2699-1213 FAX: 886-4-2699-6533  
E-mail: taining@ms14.hinet.net  
http://www.taining.tw  
www.taining.com.tw  
www.winder.com.tw

### OFFICE

盈俞股份有限公司  
INWIN W & R CORPORATION

台灣40358台中市西區向上路一段79巷50號4F  
4F., No.50, Lane. 79, Sec. 1, Xiangshang Rd.,  
West Dist., Taichung City 40358, Taiwan  
TEL: 886-4-2301-0980 FAX: 886-4-2301-2267  
E-mail:taining@inwin.tw

CE



ISO 9001

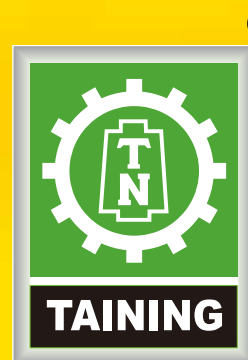

# TN-33 高性能繞線機

Excellent Type Cross Cone Winder



A Cone

Y King Spool

H Spool



## 特性 / Characteristics

- 1.突破傳統，多項改良。
- 2.速度提高，噪音降低。
- 3.操作簡單，保養容易。
- 4.花紋調整器，反應靈敏，使成型美觀。
- 5.尼龍、棉紗、塑膠、纖維均可使用。
- 6.選擇性配備：微電腦計碼器。

1. Breaking through tradition & possessing various improvement.
2. Increasing the speed & lowering noise.
3. Simple operation & easy maintenance.
4. The density adjustment is sensitive, it will make the shape of product presents fine & exquisite.
5. Suitable for nylon, cotton, s.polyester, and PP/PE yarns.
6. Optional: micro computer yarn meter.



新型輔助繞線機構  
New auxiliary winding structure



新型變速傳動機構  
New transmission structure

## 主要結構 / Major structure

1. 凸輪箱C是機器之心臟部位，由於結構改良，使得機器耐用性提高數倍。
2. 繞線軸機構B及變速箱D不用加注液體潤滑油不會造成污染，並節省保養時間與成本。
3. 新型主要結構之整體效益
  - a. 速度由1200rpm提高為1400rpm，產量增加16%。
  - b. 速度增加，但噪音減少，且節省用電，耐用性增加，成品更美觀，操作更容易。

1. Cam case C is the core of the machine, on account of the improvement, it makes machine's durability highten manifold.
2. It dose not need to add liquid lubricant into winding shaft structure B & transmission case D. It Won't produce pollution and will save the time & cost of maintenance.
3. The whole effects of the newest major structure
  - a. The speed increases from 1200rpm to 1400rpm and the quantity of production increases 16%.
  - b. Although the speed of machine has been highten, the noise has been reduced. Besides, saving electricity and increasing the durability. The product will be more fine & exquisite and the operation will be easier.

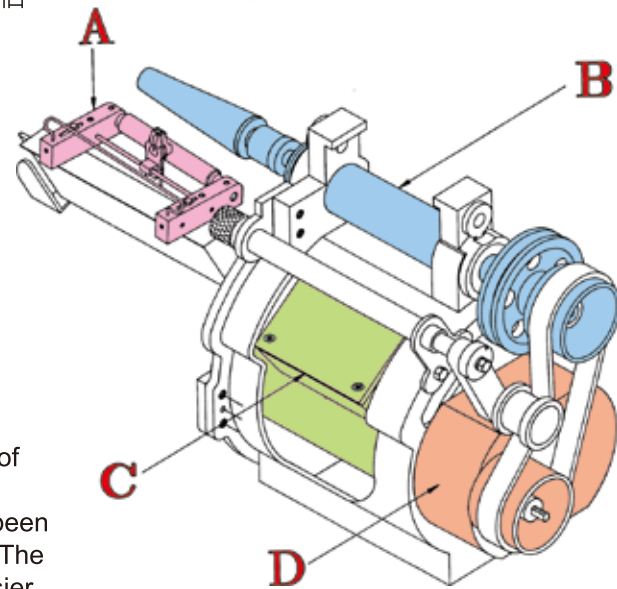

## A. 新型輔助繞線機構-A.H管專用 / New auxiliary winding structure-for bobbin A.H use only

1. 採用新設計之可調式滾輪組 a，不但有整平之功能且兼具積極送紗之主要特性，使得成型美觀符合要求。
2. 新設計之導引鉤 b 採用工程塑膠，降低磨損，且用圓軌軸道，適合各種斜度之管子。

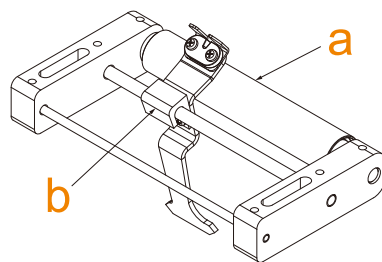

1. Using the newest design, adjustable rolling wheel a, the machine not only has function of making flat but also possesses the feature of positively sending thread ensure to meet the nice looking appearance of shapes.
2. New design of instructing hook b is made of engineering plastics and it can lower the wear and tear. In addition, it uses a round axis track to be appropriate each kind of oblique degree bobbin.

## B. 新型變速傳動機構 / The structure of the winding shaft

1. 本機構採用無油式主軸，裝配容易，精度高，由於採用2個連座軸承 a，不但適合連續運轉且不用加油。

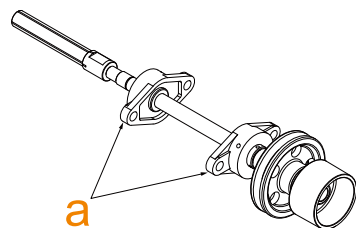

1. The change drive structure with oil-free shaft, easy assembly, high precision. with two seated bearing a, free oiling, good for continuous drive & durable.

## C. 新型凸輪機構 / The new structure of the cam cast

1. 本機構採用雙軌式設計，且驅動塊 a 採用工程塑膠，耐磨、耐衝擊，滾子心軸 b 加大尺寸，不易斷裂。
2. 凸輪 c 採用 FC25 不易磨損，並採用離心環 d 防止漏油。

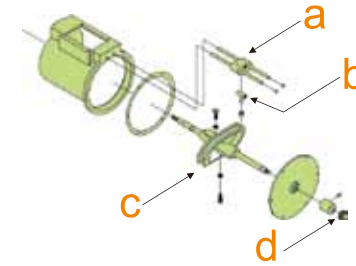

1. It is designed of double-track. Driving block a is made of engineering plastics, it is durable and has impact loading. It is not easy to break with enlarging the size of rolling shaft b.
2. The cam cast c is made of FC25, is not easy to wear. It uses centrifugal circle d can prevent from leakage oil.

## D. 新型變速傳動機構 / The transmission structure

1. 本機構不但增加一個能承受徑向與軸向力之連座軸承 a，能增加凸輪之穩定性，並採用耐磨之工程塑膠齒輪 b，低噪音且長時間運轉不用加潤滑油。
2. 變速齒輪之兩端採改用免加油之滾珠軸承 d，並且採用可拆式保護蓋 c，防塵、安全、且保養檢視容易。

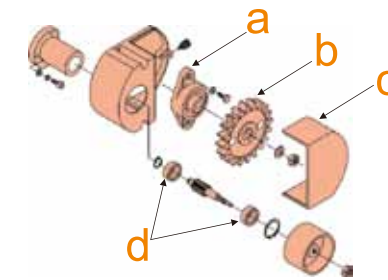

1. It not only adds a coupling shaft a, able to endure the power from radial and axial & promote the stability of cam but also has durable engineering plastics gear b, able to lower noise and dose not need to add liquid lubricant during a long period of operation.
2. Transimission gear shaft has non-adding oil balls bearing d at its two sides and dismantling protecting cover c, able to prevent from dust; safe and easy to inspect & maintain.

## E. 新型自動調整油槽機構 / New auto-regulating oiling device

1. 本機構最大特點：加大滾輪 c 配合隨錠自動調整式導引桿 d，能夠配合線速度越快而漸增線與滾軸之接觸面積，使線從開始至完成都能均勻上油，此一構造之改良大大改善因線速度漸快而上油漸減以至不均勻而導致縫紉機高速運轉斷線之問題，所以能確保線之品質。
2. 本機採用大型油槽 a 可免除時常加油與油溢出之困擾。
3. 油槽並附有一體成型之擋油板 b，可避免運轉中油滴噴出以減少污染。
4. 本機構並加裝濾油器 e，能有效的防止開車與運轉中過多的油量或油滴隨線噴出，所以能將污染降低至最低。

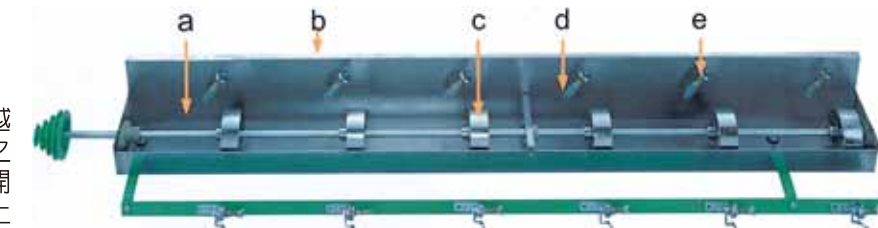

1. The large roller c drives the auto-regulating battens d, these match the winding speed and increase the contact between the thread and rollers. It allows the thread to be uniformly bathed in oil at any operating speed. This structure reduces the yarn breakage caused by unevenly adding oil during high speed operation. As the winding speed increase the oil feed is carefully regulated to ensure high quality thread.
2. This structure incorporates a large oil tank a, it reduces maintenance and oil spilling.
3. The oil damper b of the oil tank avoids oil from splashing during operation.
4. Equipped with an oil filter e that prevents excessive oil from splashing during operation. It keeps pollution to the lowest possible degree.

## 主要規格 / Main specifications

| 成型 Package shape      | MODEL - A              |                        |                        | MODEL - H  |                        |                        | MODEL - Y                  |                            |                             |
|-----------------------|------------------------|------------------------|------------------------|--|------------------------|------------------------|----------------------------|----------------------------|-----------------------------|
|                       | 1                      | 2                      | 3                      | 1  | 2                      | 3                      | 1                          | 2                          | 3                           |
| 管子角度 Taper angle      | 3°30' • 5°57'          |                        |                        | 0°0'   |                        |                        | Kingspool                  |                            |                             |
| 橫重量 Traverse          | 4"                     | 5"                     | 6"                     | 2"   | 4"                     | 6"                     | 2"                         | 4"                         | 6"                          |
| 主軸速度 Spindle speed    | 1400r.p.m.             | 1300r.p.m.             | 1150r.p.m.             | 1500r.p.m.   | 1400r.p.m.             | 1150r.p.m.             | 1400r.p.m.                 | 1300r.p.m.                 | 1100r.p.m.                  |
| 產量 Capacity (4")      | 42 LBS/8hrs (40/2S SP) | 50 LBS/8hrs (40/2S SP) | 54 LBS/8hrs (40/2S SP) | 5760pcs (100 M/8hrs)                               | 42 LBS/8hrs (40/2S SP) | 52 LBS/8hrs (40/2S SP) | 42 LBS/8hrs (210D/2 Nylon) | 79 LBS/8hrs (210D/2 Nylon) | 100 LBS/8hrs (210D/2 Nylon) |
| 每錠管子 Package capacity | 1PC                    |                        |                        | 3PC  | 1PC                    |                        |                            | 1PC                        |                             |
| 錠數 No. of spindle     |                        |                        |                        | 6SP  |                        |                        |                            |                            |                             |
| 起動裝置 Starting device  |                        |                        |                        | Slow start   |                        |                        |                            |                            |                             |
| 運轉裝置 Drive device     |                        |                        |                        | V-belt   |                        |                        |                            |                            |                             |
| 馬達電力 Motor power      |                        |                        |                        | 1HP  |                        |                        |                            |                            |                             |
| 機器重量 Weight           |                        |                        |                        | N.W. 400kgs G.W. 500kgs                            |                        |                        |                            |                            |                             |
| 機器尺寸 Floor space      |                        |                        |                        | 208L x 62W x 140H (cm)                             |                        |                        |                            |                            |                             |
| 包裝材積 Measurement      |                        |                        |                        | 2台 / 1木箱 2SETS/WOODEN CASE 210L x 140W x 110H (cm) |                        |                        |                            |                            |                             |

機器設計及規格如有變更恕不另行通知，本機器獲得多項專利，仿冒必究。 All specifications and designs subject to change without notice.